

# sunlite®

## INSTALLATION INSTRUCTIONS

LED Outdoor Wall Sconce | 81205-SU



DIMMABLE 10-100%\*

**Please read and understand this entire manual before attempting to assemble, operate or install the product.**

**WARNINGS & CAUTIONS:** Risk of fire or electric shock, avoid fire or electric shock. Turn off the power at fuse or circuit breaker box before installation and maintenance to avoid electric shock. Before installation thoroughly review enclosed installation manual. Use for 120 Volt fused circuits. This product must be installed in accordance with the applicable installation code by a person familiar with the construction and operation of the product and the hazards involved. If you do not have sufficient electrical wiring experience, please consult a qualified electrician. Consult a qualified electrician to ensure correct branch circuit conductor. Do not make or alter any open holes in an enclosure of wiring or electrical components during installation. If the product is damaged, do not attempt installation and do not use. Not for emergency lighting. Operating temperature -20°C - 45°C (-4°F - 113°F). Suitable for wet locations.

\*The lamp may not be compatible with all dimmers. Go to [www.Sunlite.com/Dimmers](http://www.Sunlite.com/Dimmers) to find dimmer compatibility information.

**AVERTISSEMENT** – Risque d'incendie ou de choc électrique. Ce produit doit être installé selon le code d'installation pertinent, par une personne qui connaît bien le produit et son fonctionnement ainsi que les risques inhérents. Consulter un électricien qualifié pour vous assurer que les conducteurs de la dérivation sont adéquats. Convient aux emplacements humides. Peut être utilisé à une température ambiante n'excédant pas 45°C. Les fils d'alimentation 90°C min. Cet appareil n'est pas destiné à être utilisé dans les issues de secours.

Retain these instructions for future reference.

v2022

## Installation & Assembly

Remove the fixture and the mounting package from the box and make sure that no parts are missing by referencing the illustrations on the installation instructions.

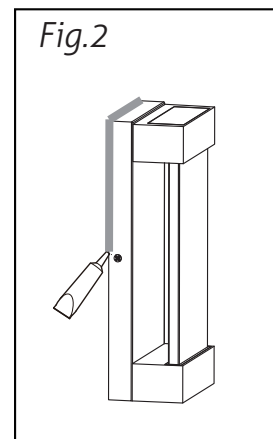
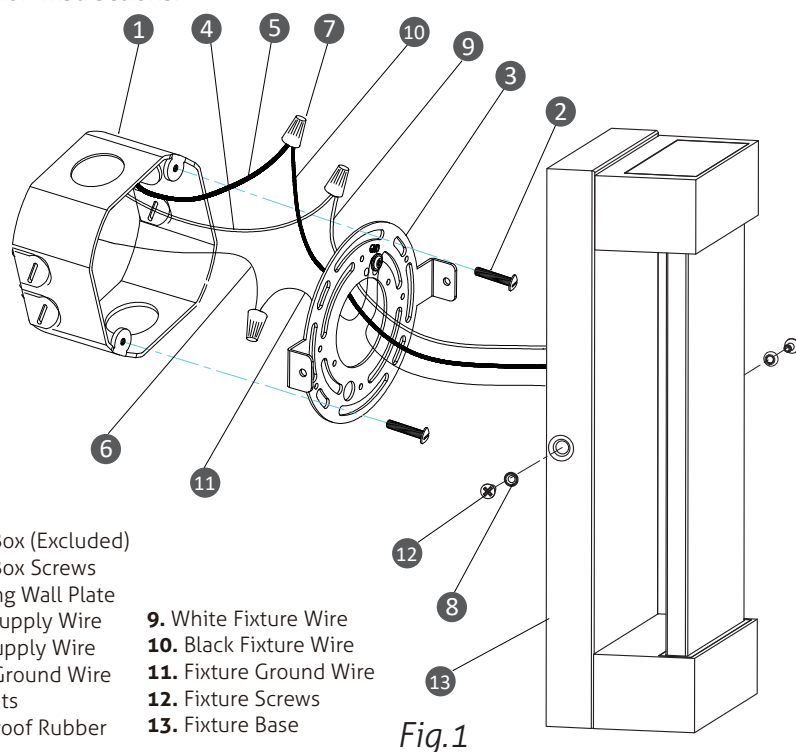

1. Place the mounting WALL PLATE (3) over the OUTLET BOX (1), align the mounting slots of the wall plate with holes of the outlet box as shown. Use a level to ensure the WALL PLATE (3) is straight.
2. Mark the location of the keyhole slots of the wall plate on the wall. Drill a holes at the narrow end of each keyhole slot marking on the wall. Carefully hammer a wall anchor into each drilled hole.
3. Pull the SUPPLY WIRES (4 & 5) and house GROUND WIRE (6) out from the OUTLET BOX (1) before attaching wall plate to outlet box. Make electrical connections, connect the BLACK FIXTURE WIRE (10) to the BLACK SUPPLY WIRE (5) and the WHITE FIXTURE WIRE (9) to the WHITE SUPPLY WIRE (4) using WIRE NUT (7). Connect the FIXTURE GROUND WIRE (11) to the SUPPLY GROUND WIRE (6) together using wire nut (7). Wrap all wire connections with electrical tape to ensure secure connection.
4. Place the FIXTURE BASE (13) over the mounting WALL PLATE (3) and secure it to the wall plate by using four WATERPROOF RUBBER (8) and FIXTURE SCREWS (12).
5. Installation complete, restore power at the circuit breaker and turn light switch on to activate this fixture.
6. After installing the fixture, caulk upper 2/3 of wire connection enclosure to mounting surface. Leave bottom 1/3 un-caulked for drainage of any water that might leak into the enclosure. The manufacturer recommends a non-drying exterior caulking material. A good example is a clear silicone rubber sealant for exterior use (**Fig. 2**)

**Care and maintenance** – Use dry and clean cloth to wipe the surface of the fixture

**Replacement**- This LED product has no bulb to replace.