

sunlite®

INSTALLATION INSTRUCTIONS

LED RECESSED SLIM DOWNLIGHT | 85554-SU, 85555-SU, 85558-SU, 85559-SU



Please read and understand this entire manual before attempting to assemble, operate or install the product.

WARNINGS & CAUTIONS: Risk of fire or electric shock. Turn power off before inspection, installation, or removal. Use only on 120 volt circuits. Before installation, thoroughly review enclosed installation manual. This product must be installed in accordance with the applicable installation code by a person familiar with the construction and operation of the product and the hazards involved. If you do not have sufficient electrical wiring experience, please consult a qualified electrician. All work should be done by a qualified electrician. Do not make or alter any open holes in an enclosure of wiring or electrical components during installation. To prevent wiring damage or abrasion, do not expose wiring to edges of sheet metal or other sharp objects. Do not install this fixture where there is risk of rain or moisture exposure. Install this kit only in the luminaires that have the construction features and dimensions shown in the instructions. Not for emergency lighting. Type IC - Inherently Protected. Operating temperature -20°C – 40°C (-4°F – 104°F). Suitable for damp locations.

Retain these instructions for future reference.

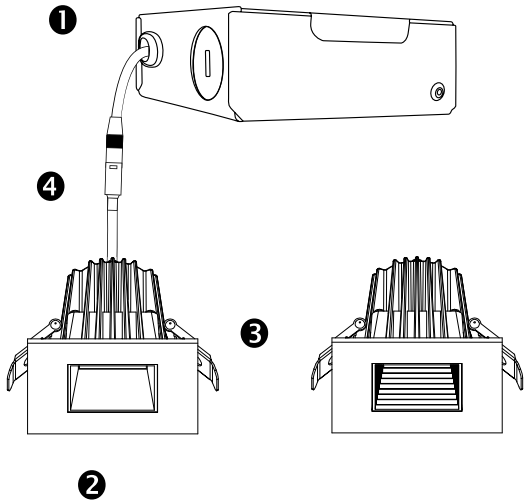

PARTS LIST / LISTE DES COMPOSANTS

- 1 Junction box / Boîte de jonction
- 2 Deep anti-glare downlight / Lampes à encastrement profond
- 3 Spring clips / Agrafe-ressort
- 4 Connector / Connecteur

COMPATIBLE DIMMER LIST

Leviton: 6672 /6674

Lutron: CTCL-153P, DVCL-153P, S-600P, SLV-600P, CN-600P, DVWCL-153P, CTCL-153PR ,DVCL-153PR

Specification	Power	Voltage	Outer Diameter	Thicknes	Cutout Size	Equivalent to	Application
2" Square Downlight	8W	120V AC / Dimmable	3-1/5"*3-1/5"(80*80mm)	2-1/5" (57mm)	2-3/5" (65mm)	60W Halogen	IC Rated
4" Square Downlight	12W	120V AC / Dimmable	4-4/5"*4-4/5"(122*122mm)	2-1/2" (64mm)	4-1/4" (108mm)	90W Halogen	IC Rated
4" Square Downlight	15W	120V AC / Dimmable	4-4/5"*4-4/5"(122*122mm)	2-1/2" (64mm)	4-1/4" (108mm)	110W Halogen	IC Rated

MAINTENANCE ENTRETIEN

- **Do not modify this fixture. Any modifications may render the product unsafe and void warranty.**
N'apportez pas de modifications à cet appareil. Toute altération risque de rendre l'appareil dangereux et d'annuler la garantie.
- **This product is suitable for damp locations.**
Ce produit convient aux endroits mouillés.

INSTALLATION GUIDE

⚠ WARNING

Turn power OFF from electrical panel before installation or maintenance.

1. Turn power OFF from the electrical panel prior to installation.
2. Determine the location for installation and cut ceiling hole in accordance with cut-hole dimensions. Refer to *Hole Diameter* table for appropriate sizes. (Fig. 1)
3. Open the junction box cover and remove the appropriate knockout(s) on the side panel. (Fig. 2)
4. Insert the electrical supply cable through the knockout and secure with a cable connector (sold separately).
5. Using quick-connect push-in terminals, connect the ground wire to the green wire terminal; black wire to black wire terminal; white wire to white wire terminal. (Fig. 2)
6. Place all wiring and connections back in to the box and close the cover. Connect the driver to the light panel.
7. Insert junction box through the mounting hole. (Fig. 3)
8. Push spring-loaded clips on the fixture upwards and insert fixture base in to the mounting hole. Release the clips and fixture will be pulled flush to the ceiling. (Fig. 4)

Fig. 1

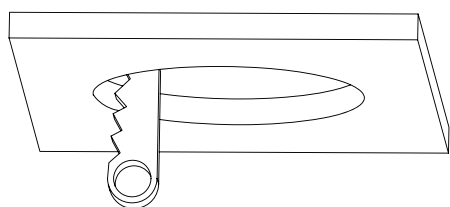

Hole diameter/Diamètre de perforation:

2"	ø2-3/5" (65mm)
4"	ø4-1/4" (108mm)

Fig. 3

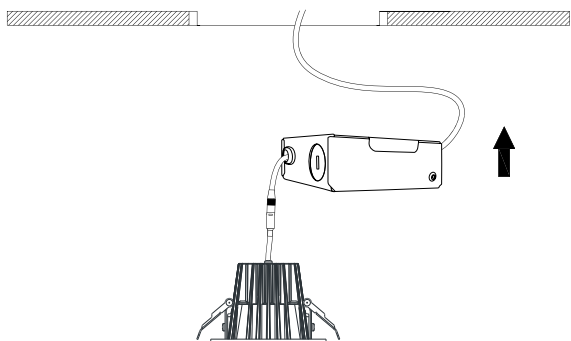

⚠ MISE EN GARDE

Mettez l'interrupteur hors tension ou coupez le courant avant de remplacer ou d'entretien.

1. Coupez l'électricité à partir du panneau électrique avant de commencer l'installation.
2. Déterminez un endroit approprié pour l'encastré. Mesurez et coupez un trou conformément aux dimensions de perçage. Voir le tableau approprié à la taille. (Fig. 1)
3. Ouvrez le couvercle de la boîte de jonction et retirez l'entrée défonçable appropriée. (Fig. 2)
4. Insérez le câble d'alimentation électrique par l'entrée défonçable et le fixer avec un connecteur de câble (vendu séparément).
5. À l'aide des connecteurs de fils, branchez le fil de mise à la terre au connecteur du fil vert; le fil noir au connecteur du fil noir; le fil blanc au connecteur du fil blanc. (Fig. 2)
6. Placez tout le câblage et les connexions dans la boîte et fermez le couvercle. Branchez le circuit et le luminaire.
7. Insérez la boîte de jonction à travers le trou de montage. (Fig. 3)
8. Pousser les agrafes-ressorts du luminaire vers le haut et insérez la base de l'appareil dans le trou de montage. Relâchez les agrafes-ressorts jusqu'à ce que le luminaire affleure le plafond. (Fig. 4)

Fig. 2

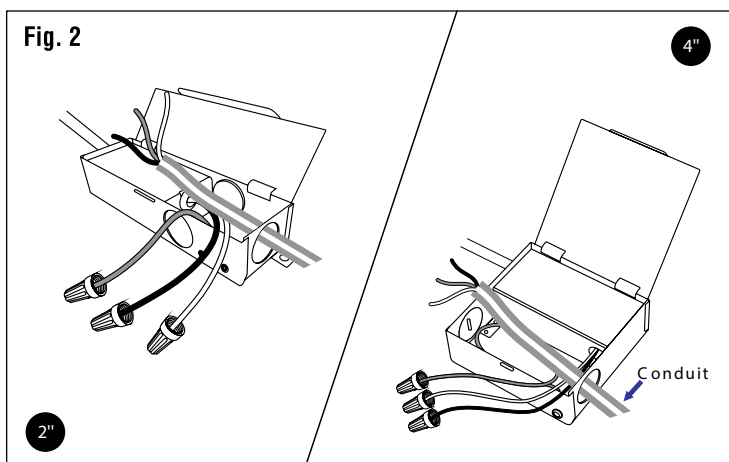

Fig. 4

