

INSTALLATION INSTRUCTIONS

LED OUTDOOR WALL LIGHT

Please read carefully and save these instructions, as you may need them at a later date.

CAUTION

Turn off the main power at the circuit breaker before installing and servicing the fixture, in order to prevent possible shock.

GENERAL

All electrical connections must be in accordance with local and National Electrical Code (N.E.C.) standards. If you are unfamiliar with proper electrical wiring connections, obtain the services of a qualified electrician.

Remove the fixture and the mounting package from the box and make sure that no parts are missing by referencing the illustrations on the installation instructions.

ASSEMBLY AND INSTALLATION

- 1: Place the mounting wall plate(3) over the outlet box(1), align the mounting slots of the wall plate(3) with holes of the outlet box(1) as shown. Use a level to ensure the wall plate(3) is straight.
 - 2: Mark the location of the keyhole slots of the wall plate(3) on the wall. Drill a $\frac{1}{8}$ " holes at the narrow end of each keyhole slot marking on the wall. Carefully hammer a wall anchor into each drilled hole.
 - 3: Replace the mounting wall plate(3) over outlet box(1), align the narrow end of each keyhole slot with its respective wall anchor. Feed the anchor screws(9) through keyhole slots and thread them into the wall anchors until wall plate(3) is flush against the wall. Additionally, fasten the wall plate to thread holes in outlet box(1) using two outlet box screws, as shown.
 - 5: Pull the supply wires and house ground wire(6) out from the outlet box(1) before attaching wall plate to outlet box. Make electrical connections, connect the black fixture black wire(4) to the black supply wire(10) and the white fixture wire(5) to the white supply wire(11) using wire nut (7). Connect the fixture ground wire(12) to the supply ground wire(6) together using wire nut(7). Wrap all wire connections with electrical tape to ensure secure connection.
 - 6: Screw the fixture cap nut(14) into the mounting bracket, and thread the hex nuts into fixture screws. Secure the fixture screws by tightening hex nut against the mounting bracket.
 - 7: Slide the acrylic lens (15) into the fixture body(13). Place the cover(16) on the fixture body and secure with the 3pcs final(17)
- This is integrated led fixture, no bulbs to replace.

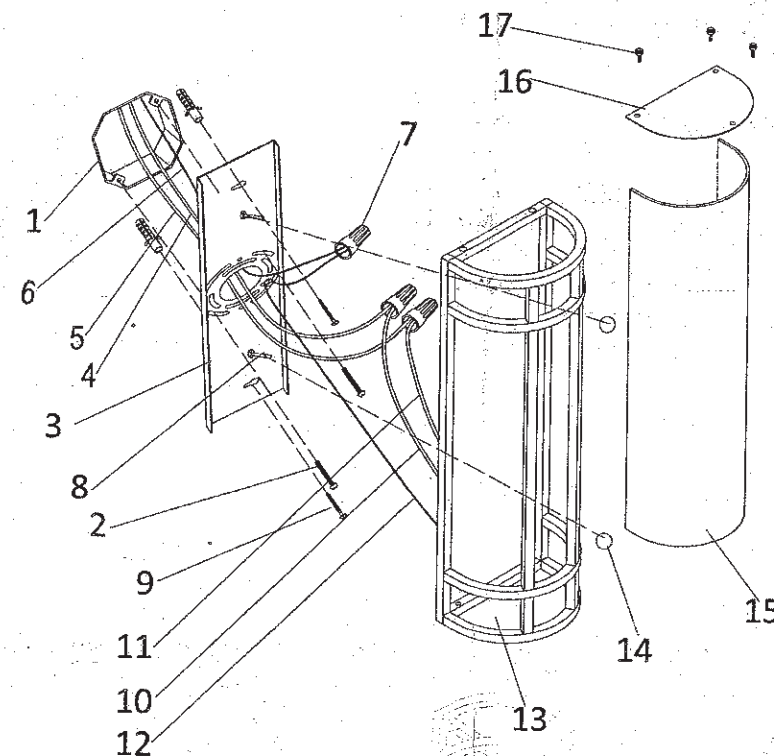

- | | |
|------------------------------|-------------------------|
| 1. OUTLET BOX (NOT INCLUDED) | 10. BLACK FIXTURE WIRE |
| 2. UTLET BOX SCREWS | 11. WHITE FIXTURE WIRE |
| 3. BACK PLATE | 12. FIXTURE GROUND WIRE |
| 4. BLACK SUPPLY WIRE | 13. FIXTURE BODY |
| 5. WHITE SUPPLY WIRE | 14. CAP NUT |
| 6. GROUND WIRE | 15. ACRYLIC LENS |
| 7. WIRE NUT | 16. COVER |
| 8. BACK SCREWS | 17. FINAL |
| 9. ANCHOR SCREWS | |