

sunlite®

INSTALLATION INSTRUCTIONS

LED RETROFIT GIMBAL RECESSED DOWNLIGHT | 82084-SU



Please read and understand this entire manual before attempting to assemble, operate or install the product.

WARNING: Risk of fire or electric shock. Turn power off before inspection, installation, or removal. Use only on 120 volt circuits. Before installation, thoroughly review enclosed installation manual. This product must be installed in accordance with the applicable installation code by a person familiar with the construction and operation of the product and the hazards involved. If you do not have sufficient electrical wiring experience, please consult a qualified electrician. Non-IC Rated. Not to be used for emergency lighting. Operating temperature -20°C – 40°C (-4°F – 104°F). Suitable for wet locations.



Do not make or alter any open holes in an enclosure of wiring or electrical components during kit installation. To prevent wiring damage or abrasion, do not expose wiring to edges of sheet metal or other sharp objects. THIS FIXTURE BODY IS ONE PIECE, DO NOT DISASSEMBLE OR MAKE ALTERATIONS.

This device complies with part 15 of the FCC Rules. Operation is subject to the following two conditions: (1) this device may not cause harmful interference, and (2) this device must accept any interference received, including that may cause undesired operation.

*The lamp may not be compatible with all dimmers. Go to www.Sunlite.com/Dimmers to find dimmer compatibility information.

Retain these instructions for future maintenance reference.

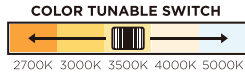

Installation

STEP 1. Make sure the power is turned off at the source to the recessed housing(s) that you are installing the fixture(s) in. Remove existing trim and CFL, or Incandescent bulbs.

STEP 2a. Unscrew the screws on socked bracket, push bracket upward to the top location. (Fig. 1a)

STEP 2b. Remove existing socket mounting plate from the recessed housing and then remove lamp socket from the plate. (Fig. 1b)

STEP 3. Screw E26 base adapter into socket in recessed housing. (Fig. 2)

STEP 4. Select desired CCT. (Fig. 3)

STEP 5. Plug E26 base cable connector into the LED Recessed Kit. Make sure the kit is grounded. (Fig. 4)

STEP 6. Squeeze torsion springs together as shown and install into torsion spring brackets inside recessed housing. For proper installation, the torsion springs should be seated within the brackets and on both sides of the housing. (Fig. 5)

STEP 7. Carefully route wires into fixture and push Recessed Kit up flush to ceiling surface. Push the edge of the bezel to tilt lens up to 30°. Rotate lens assembly horizontally towards the surface to be illuminated. (Fig. 6)

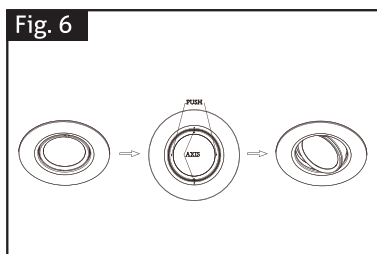
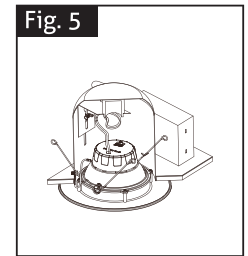
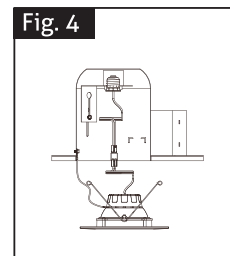
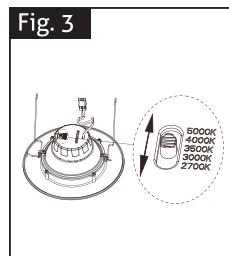
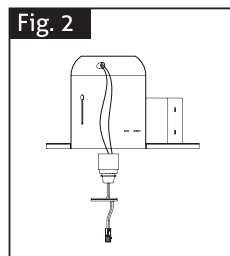
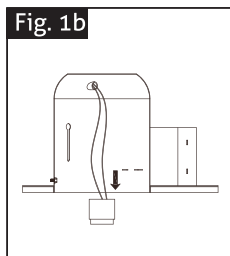
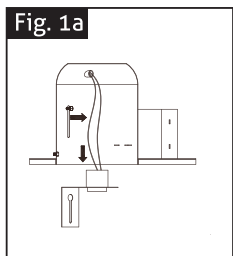

Fixture Dimensions

